

CAVENDISH SEWER UTILITY

7591 Cawnpore Lane
Cavendish, PE, C0A 1N0

SEWER CONNECTION APPLICATION

I hereby make application to connect _____ to the
Cavendish Sewer Utility sewerage system. (property number)

1. I certify that, in accordance with Island Regulatory and Appeals Commission Regulation 4.15 I have / have not installed a check valve in this building.
(circle one)
* THE CAVENDISH SEWER UTILITY STRONGLY RECOMMENDS ALL BUILDINGS CONNECTION TO THE SEWER SYSTEM BE EQUIPPED WITH A CHECK VALVE (BACK WATER VALVE).
2. I agree not to backfill the section from the lot line to the building connection or forty (40) feet, whichever is less, prior to inspection by the Cavendish Sewer Utility. If the latter, a cleanout has been installed at forty (40) feet from the lot line.
3. I agree not to connect a generator to the well pump.
4. I understand the property owner is responsible for the cost of installations from the building to the lot line.
5. I am aware the Cavendish Sewer Utility is responsible for the connection from the lot line and the cutting into the main sewer line.
6. The existing septic tanks shall be pumped and filled within 14 days from the date of inspection. All costs incurred are the responsibility of the property owner.
7. The installation shall comply with the "MINIMUM REQUIREMENTS TO CONNECT" listed on the back.

Date

Signature of Applicant

Name of Contractor
(please print)

Name of Property Owner
(please print)

APPROVED: _____
Date

CAO

INSPECTION CERTIFICATE

This is to certify that I have inspected the work carried out under the terms of the above permit and have found such work satisfactory.

DATED AT CAVENDISH, PE THIS _____ DAY OF _____ 20_____

Tim LeLacheur, Inspector
CBCL Ltd.

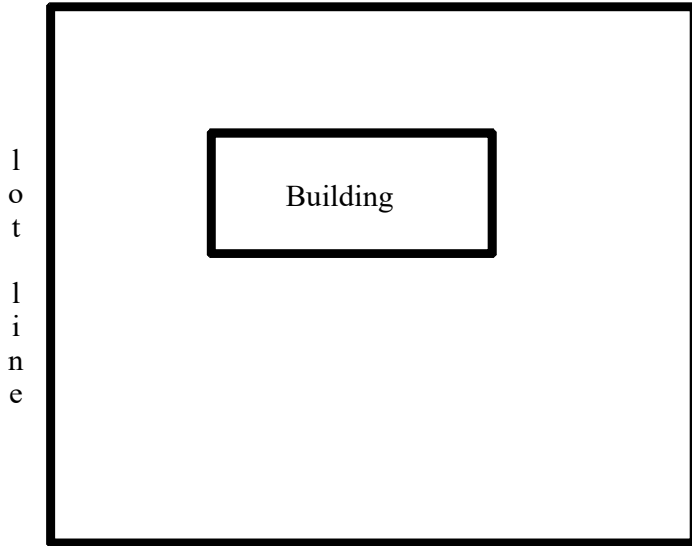

l
o
t

l
i
n
e

l
i
n
e

* INSPECTOR will indicate location of lateral noting distance from lot line at point of entry and connection to main. Also, any bends in the line must be shown and nearest manhole will be indicated.

- | | | | |
|-------------------------|------------------------------|-----------------------------|------------------------------|
| Tanks pumped and filled | yes <input type="checkbox"/> | no <input type="checkbox"/> | |
| Cleanout installed | yes <input type="checkbox"/> | no <input type="checkbox"/> | n/a <input type="checkbox"/> |
| Interceptor installed | yes <input type="checkbox"/> | no <input type="checkbox"/> | n/a <input type="checkbox"/> |

CAVENDISH SEWER UTILITY MINIMUM REQUIREMENTS TO CONNECT

1. All internal plumbing shall be in accordance with the Provincial Plumbing Codes.
2. Interbal plumbing shall extend three (3) feet beyond the outside of the foundation using Type 1, Grade 2, 4" O ABS. As well a minimum 4" cleanout is to be located immediately inside the foundation wall.
3. All piping used for service connections shall be CSA approved PVC DR-35 gravity sewer pipe, with gasket joints.

4. All connections to the sewer line shall be by means of a PVC saddle, Wye, or Tee.
5. Minimum allowable lateral grade is to be 2.0%.
6. All bends in the service must be made using "long radius" or "sweep" type PVC elbows. The maximum bend or turn in the system shall be 45 degrees.
7. Service lines to be properly bedded, hand backfilled and tamped to a minimum of one (1) foot above the pipe. Compaction required above this level is up to the home owner and contractor. Service lines to a maximum of forty (40) feet from the lot line to be bedded in sand, compacted, for the full trench width, from six (6) inches under to twelve (12) inches over the service line.
8. The service shall be used for sanitary sewer only. No sump pumps, floor drains, roof drains, etc., are allowed connections into the system.
9. All generators shall be disconnected from water supplies which discharge into the sanitary sewer system.
10. Where length of connection pipe from lot line to building connection exceeds forty (40) feet, a cleanout shall be installed a maximum of forty (40) feet from the lot line.
11. Pipe from the lot line to the cleanout shall be the same size pipe as provided by the Utility from the main line to the lot line.
12. Interceptors shall be installed according to the requirements of the current edition of the Canadian Plumbing Code.
13. The Municipal Sewer System is governed by the Island Regulatory and Appeals Commission of P.E.I. All connections must conform to all regulations and restrictions as prescribed by the Island Regulatory and Appeals Commission.
14. The Utility (or its representative) reserves the right to inspect all internal and external plumbing at any time to ensure the proper usage of the system. If improper hook-ups are discovered during an inspection the service will be disconnected at the owners expense and fined a maximum of five hundred (500) dollars.
15. If you have any questions, please call the Community Office at 963-2698

NOTE: The Cavendish Sewer Utility requests 48 hours notice of sewer connection. The notice ensures our sewer engineer will be available for inspection without causing contractors lost time.

The Cavendish Sewer Utility sewer inspection fee for all sewer connections will be billed directly to the property owner upon completion of the sewer inspection. This charge is levied against the property owner. Property owners will be billed accordingly. **THE CAVENDISH SEWER UTILITY WILL NOT ACCEPT PAYMENT OF THIS FEE FROM CONTRACTORS.**